

# DIGI ULISSE P I/E

Digital sliding gauge with spring system for internal/external grooves

Calibro a corsoio con precarica per gole interne/esterne

## GAUGES FOR GROOVES CALIBRI PER GOLE



- Digital sliding gauge for internal/external grooves
- In hardened stainless steel
- Electronic IP67 mm/inc
- Interchangeable rods
- Calibro a corsoio per gole interne/esterne
- In acciaio inox temprato
- Elettronica IP67 mm/inc
- Puntali intercambiabili

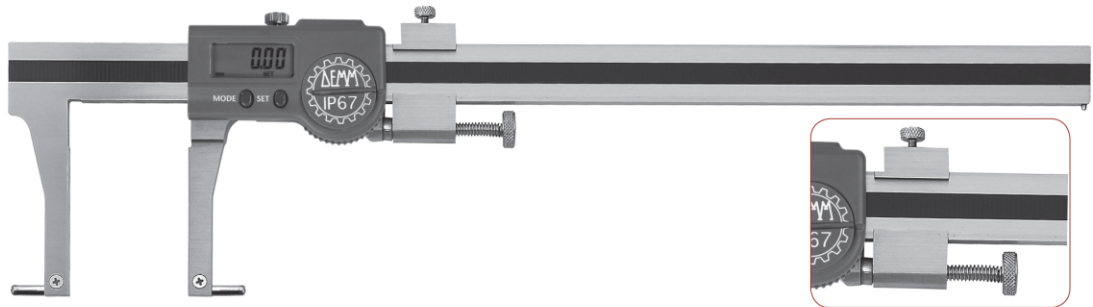

Internal application  
Applicazione per interni

External application  
Applicazione per esterni

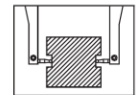
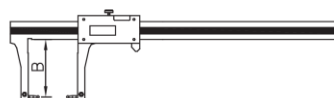
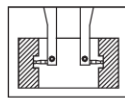
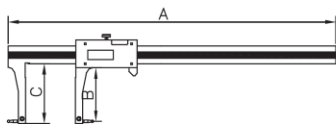

Article	Range	A	B	C	Bar Section	Resolution	Accuracy	Code	Kg
DIGI ULISSE P I/E 250	I	24-250	332	52	16X4,5	0,01	0,02	07165	0,295
	E	0-210	332	61					

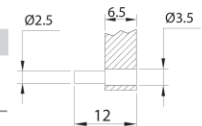

Article	Range	A	B	C	Bar Section	Resolution	Accuracy	Code	Kg
DIGI ULISSE P I/E 350	I	44-370	470	96	17 x 5	0,01	0,03	07164	0,630
	E	0-270	470	100					
DIGI ULISSE P I/E 450	I	44-470	570	96	17 x 5	0,01	0,03	07172	0,710
	E	0-370	570	100					

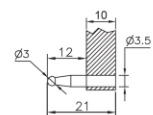

## OPTIONAL INTERCHANGEABLE ENDS DIGI ULISSE OPTIONAL TERMINALI INTERCAMBIABILI PER DIGI ULISSE

Terminali per misurazioni di passi:  
METRICO 0,8 - 1 - 1,25 - 1,5 - 1,75 - 2 - 2,5 - 3  
WITWORTH 6 - 8 - 10 - 12 - 16  
GAS 11 - 14 - 19

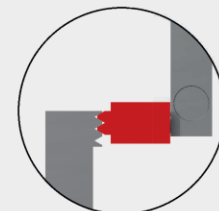
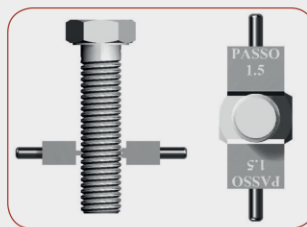
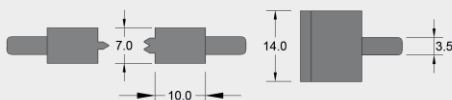

SCHEME ALL MEASURES AVAILABLE ON PAG. 16  
TABELLA CON TUTTE LE MISURE A PAG. 16

Terminali per controllo modulo filettature trapezio:

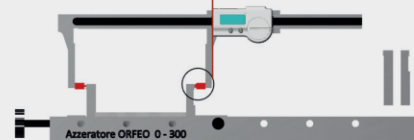
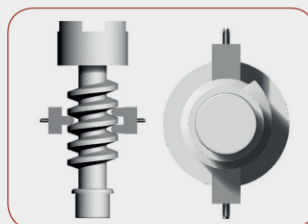
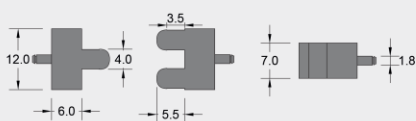

SCHEME ALL MEASURES AVAILABLE ON PAG. 16  
TABELLA CON TUTTE LE MISURE A PAG. 16